

PLANTA BAIXA - P1  
Esc 1/25

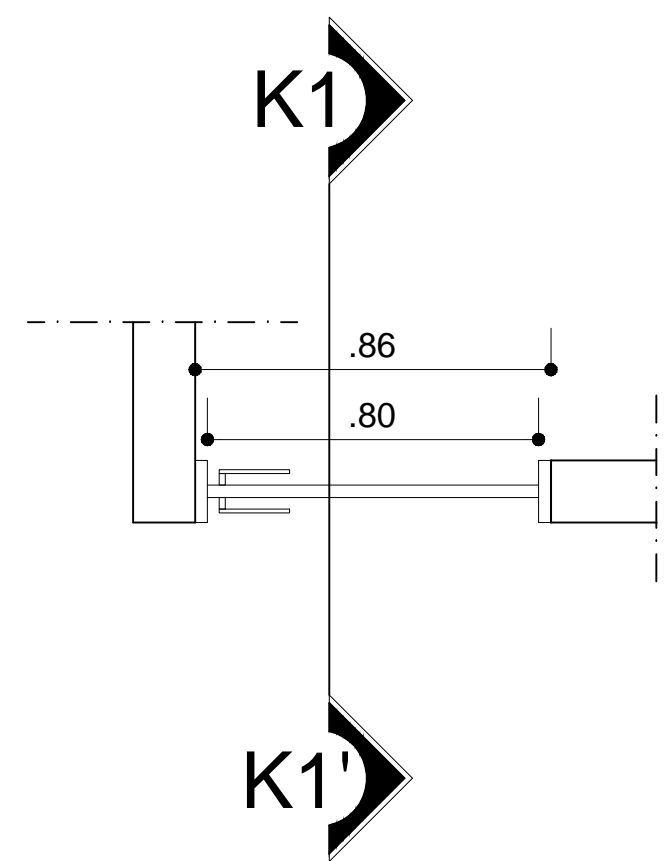

PLANTA BAIXA - P2  
Esc 1/25

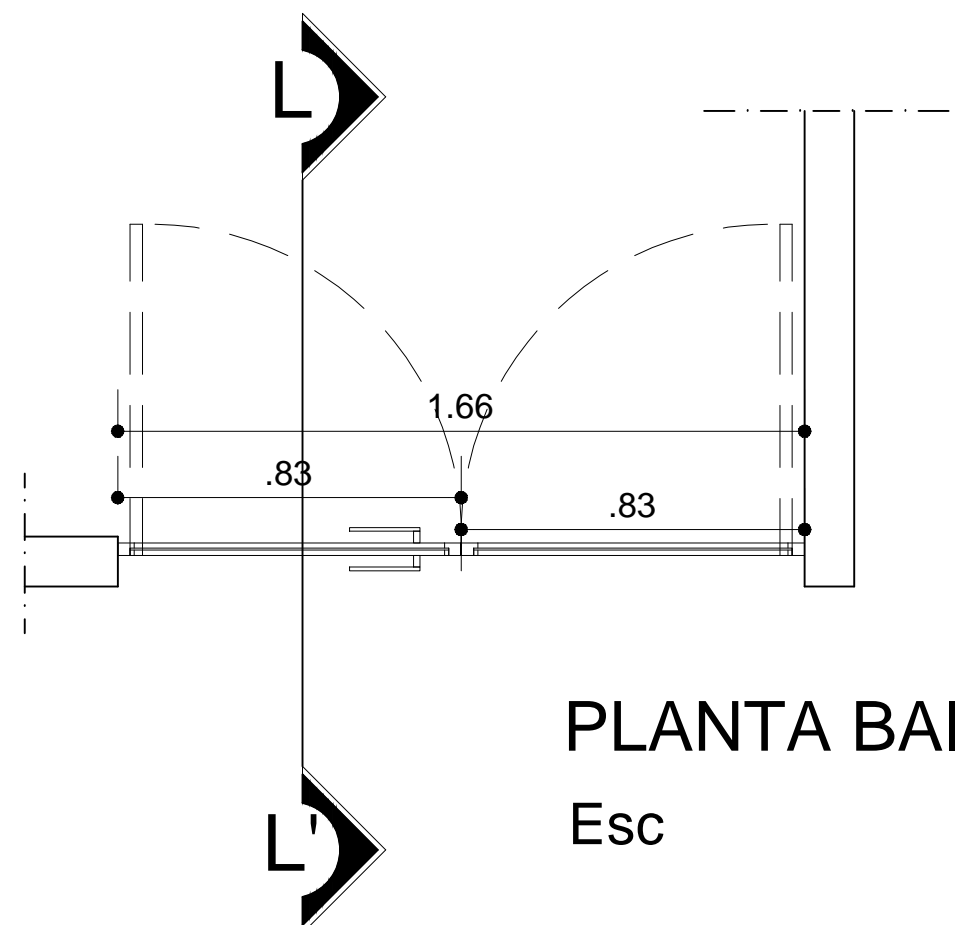

PLANTA BAIXA - P6  
Esc 1/25

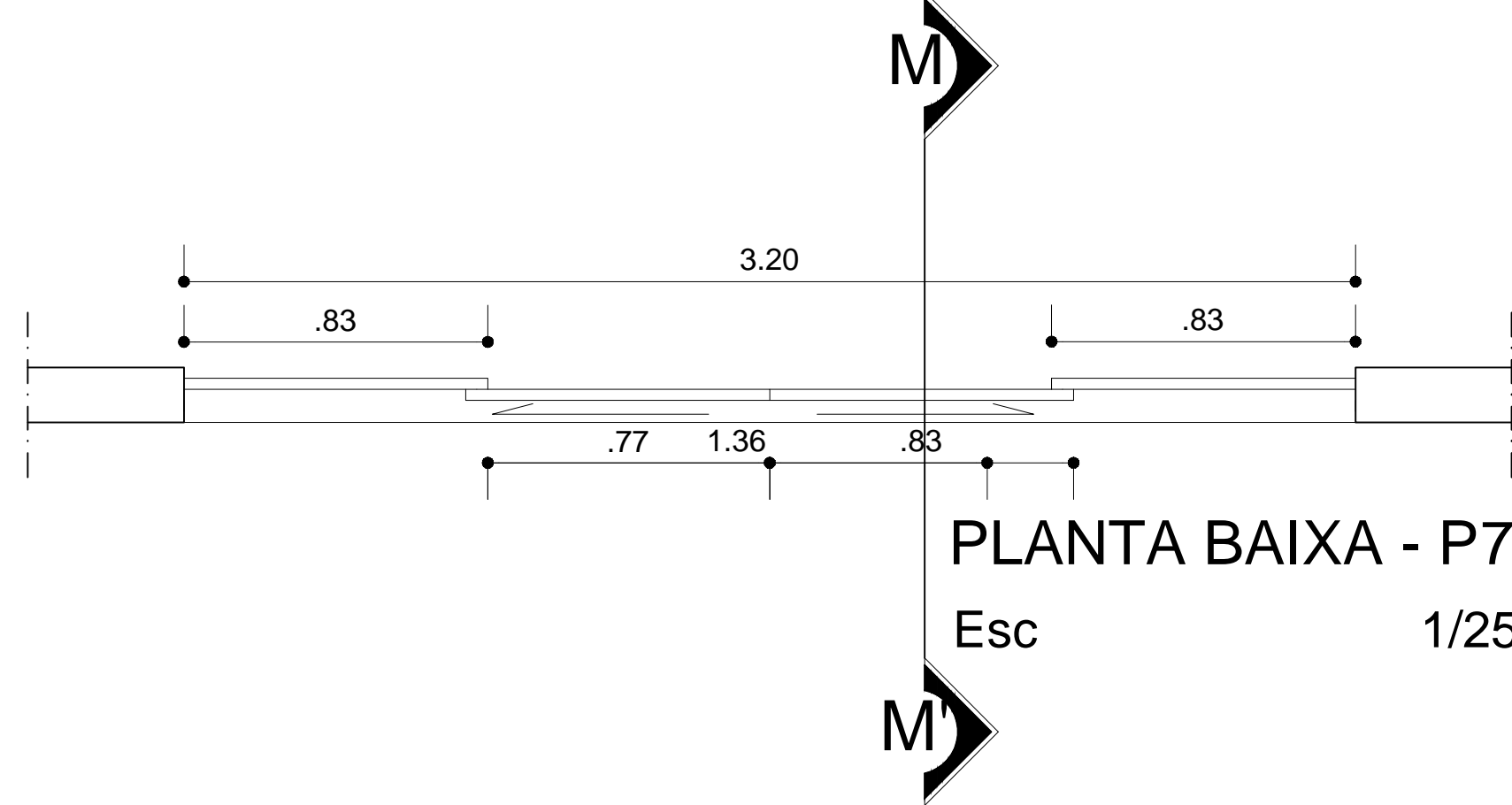

PLANTA BAIXA - P7  
Esc 1/25

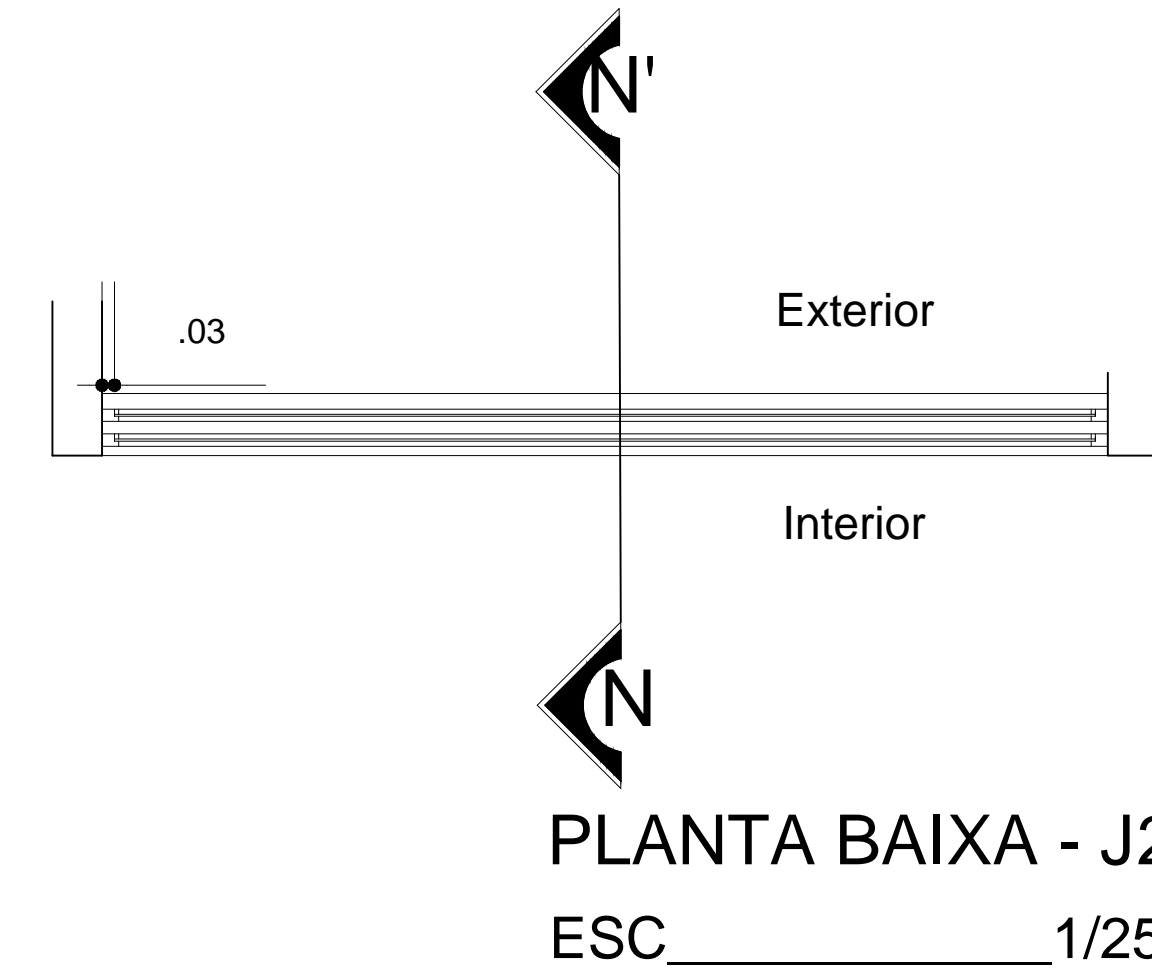

PLANTA BAIXA - J2  
ESC 1/25

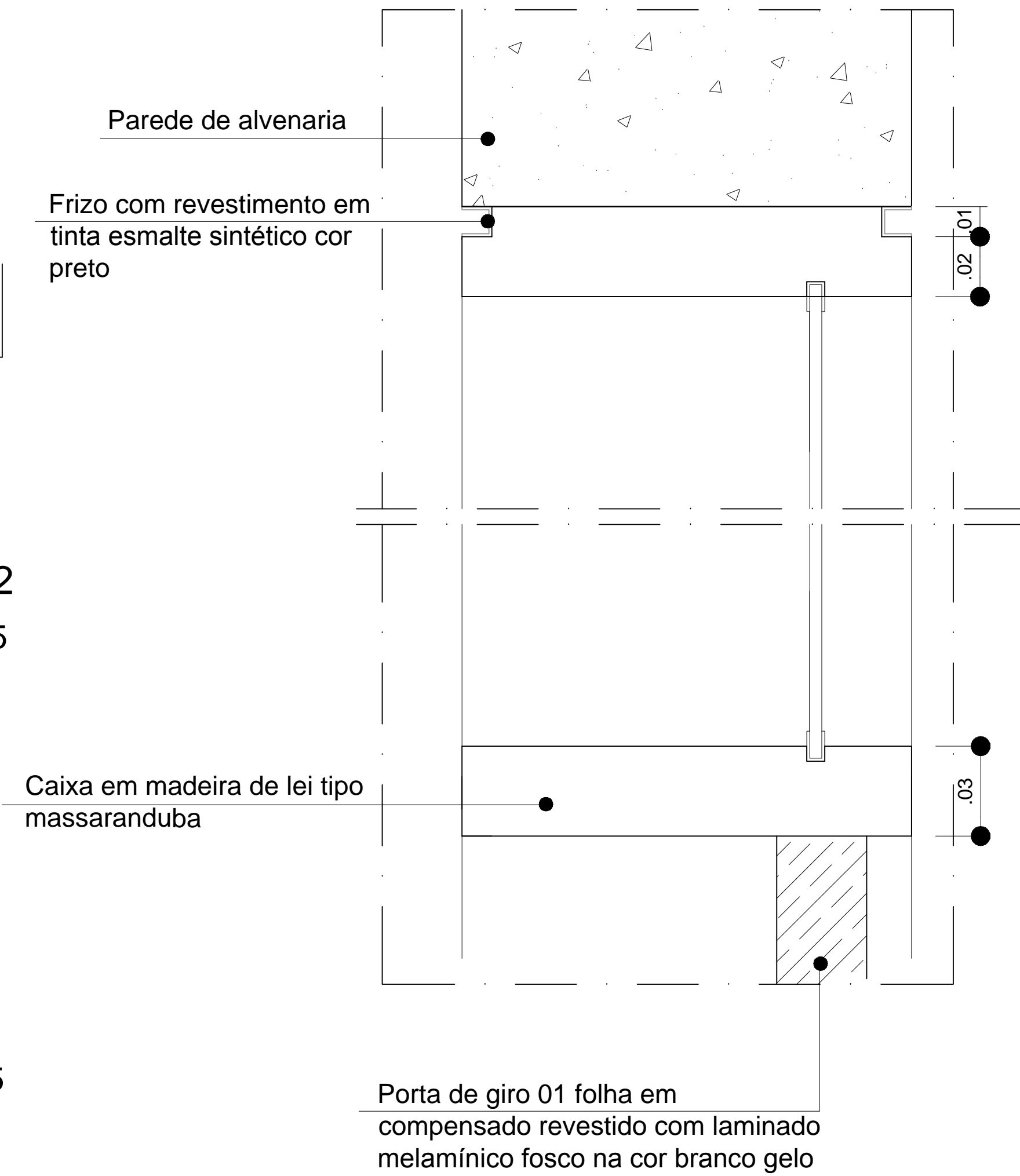

DETALHE 02  
Esc 1/2

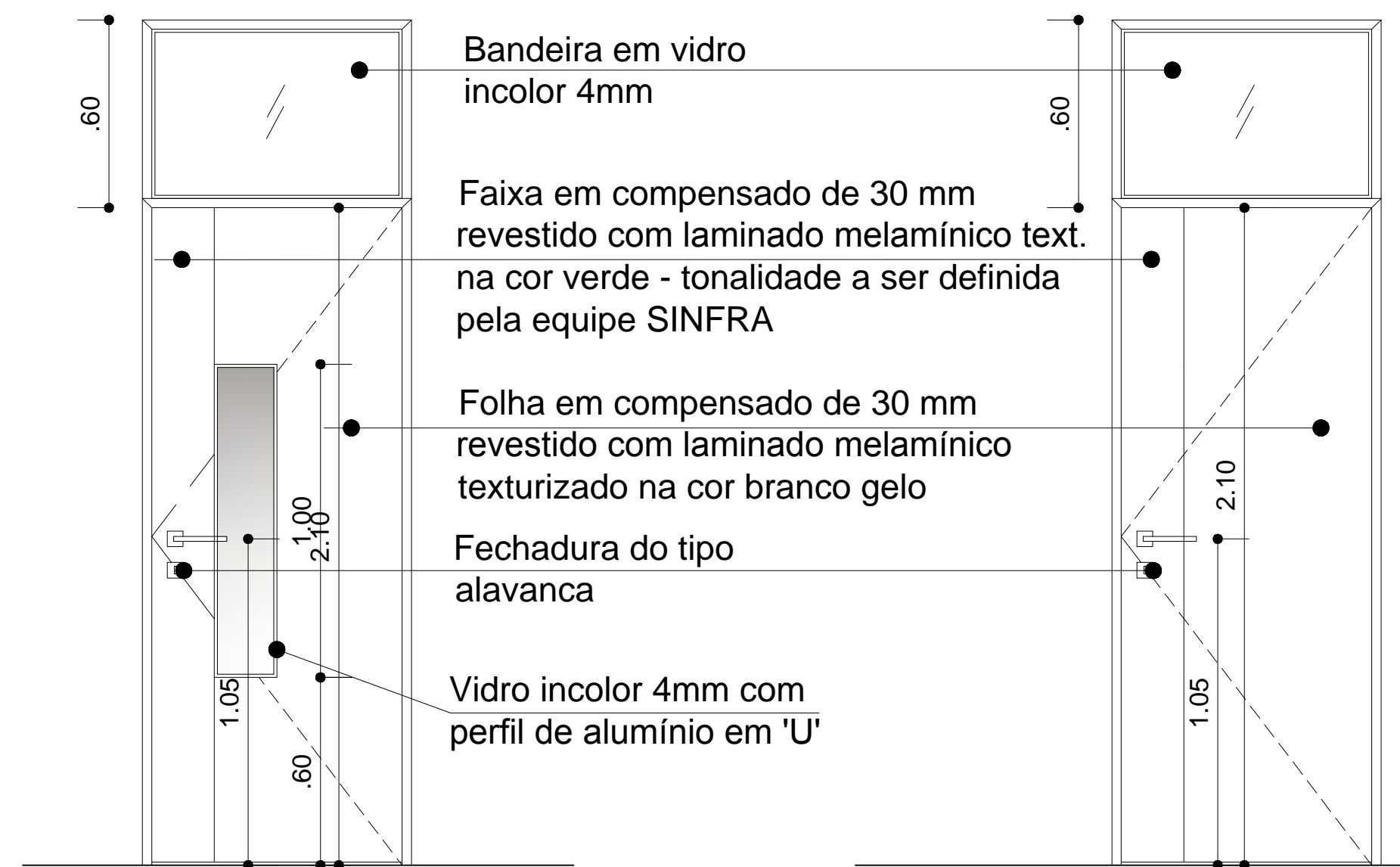

VISTA FRONTAL - P1  
Esc 1/25

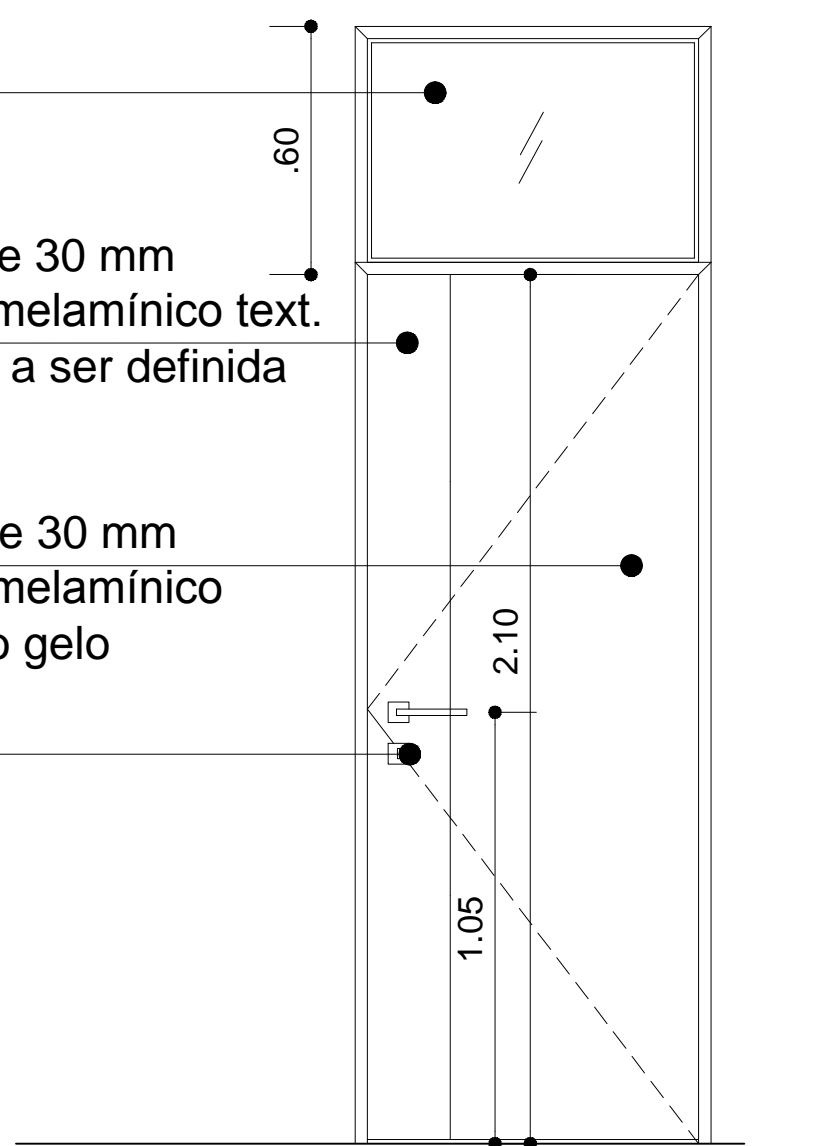

VISTA FRONTAL - P2  
Esc 1/25

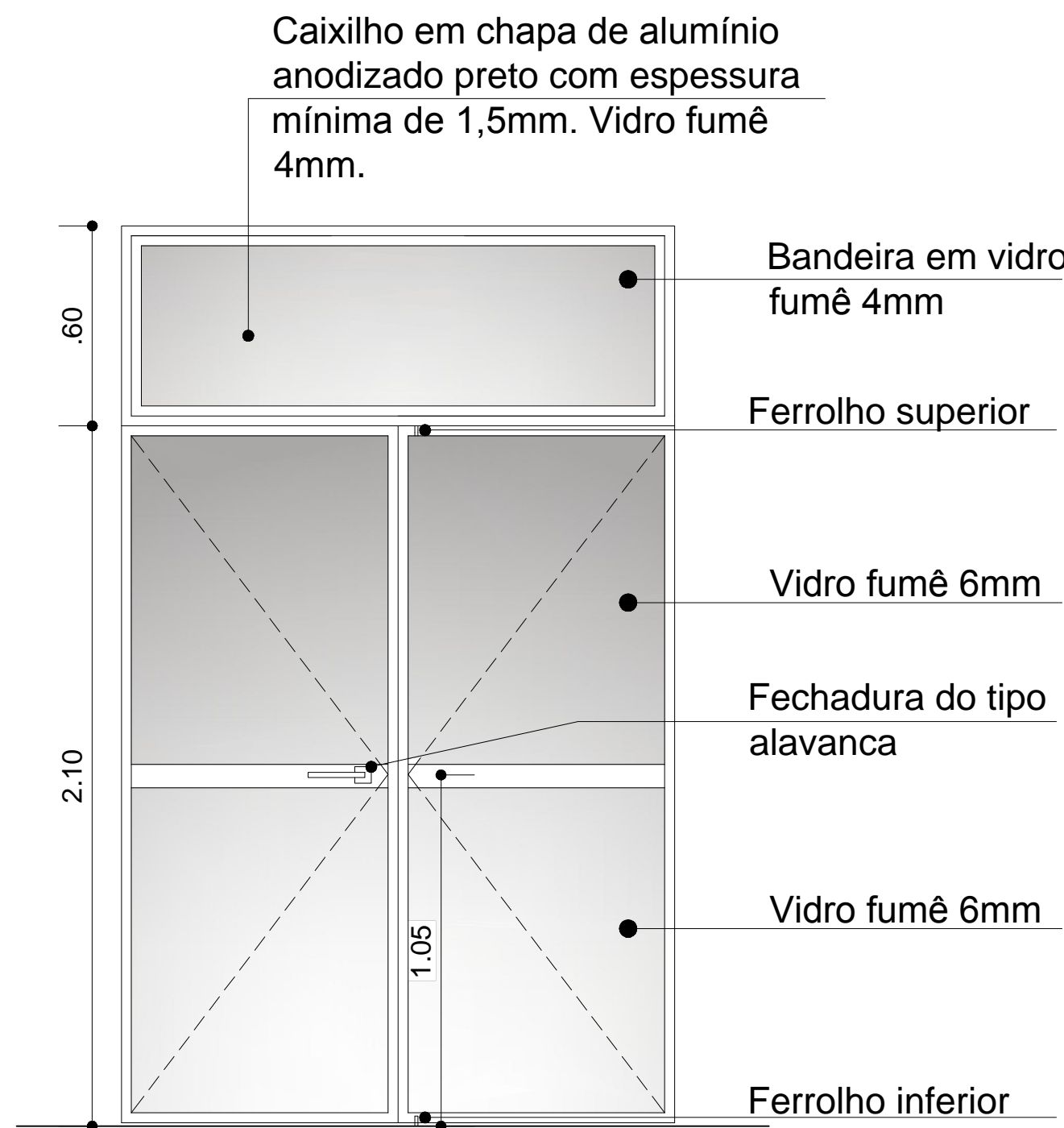

VISTA FRONTAL - P6  
Esc 1/25

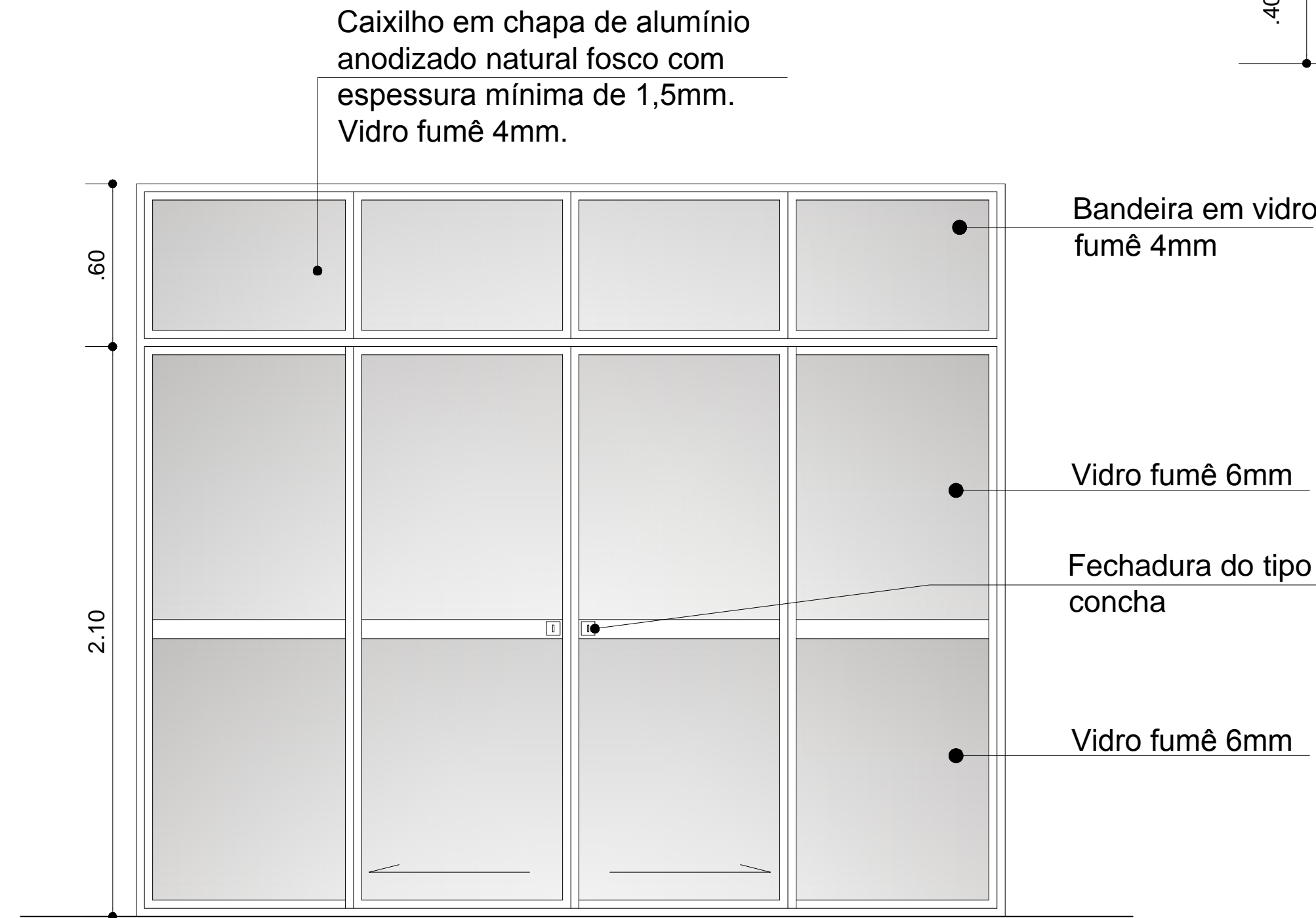

VISTA FRONTAL - P7  
Esc 1/25

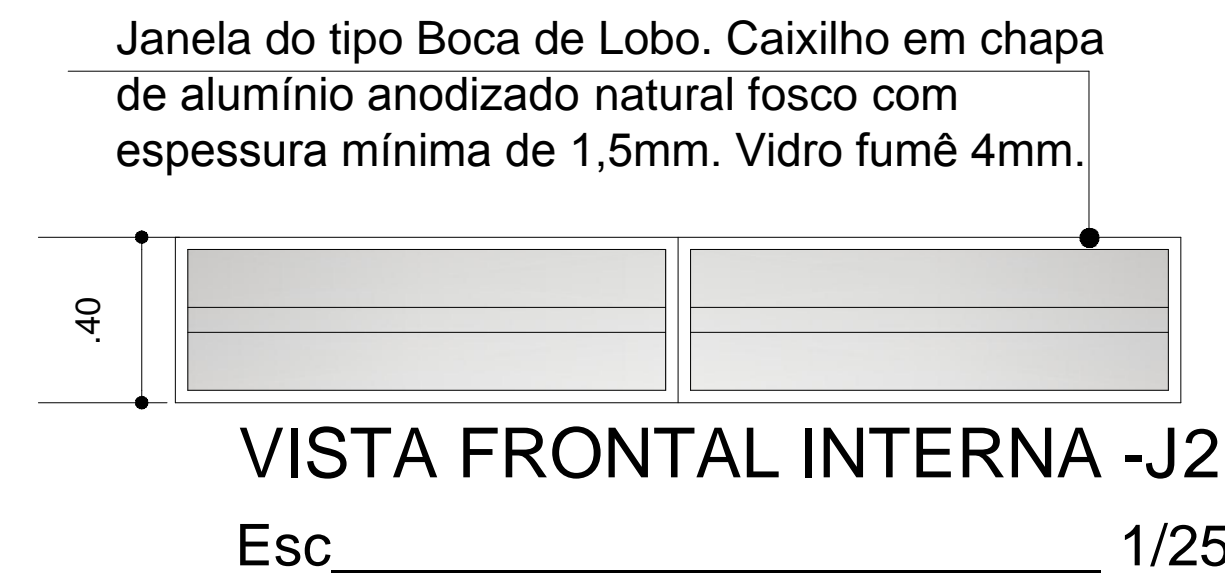

VISTA FRONTAL INTERNA - J2  
Esc 1/25

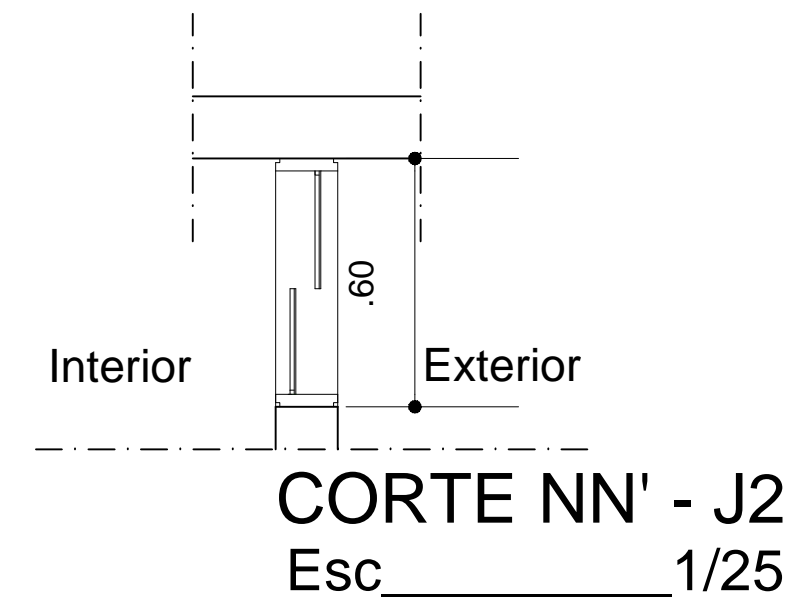

CORTE NN' - J2  
Esc 1/25

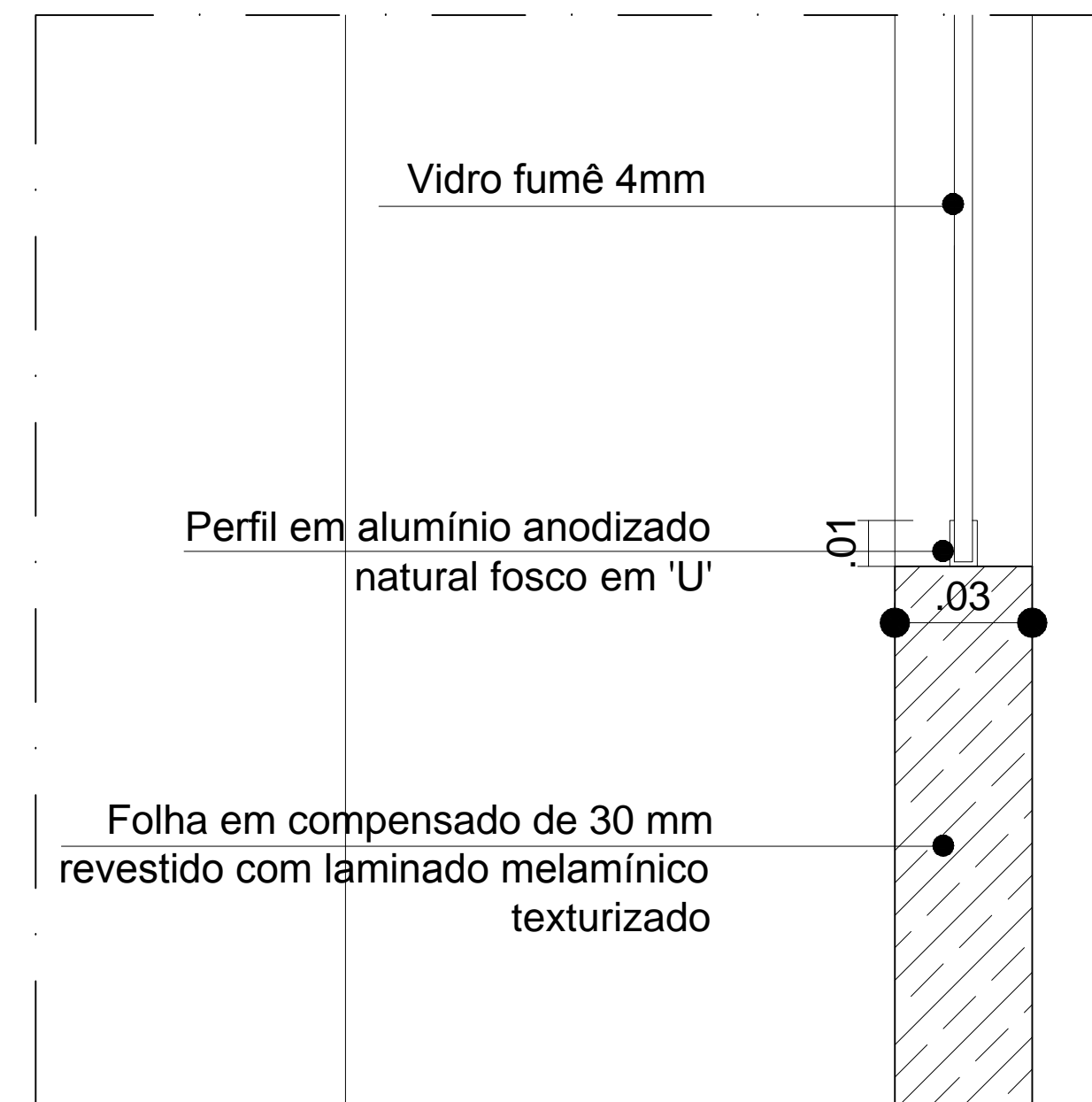

DETALHE 04  
Esc 1/2

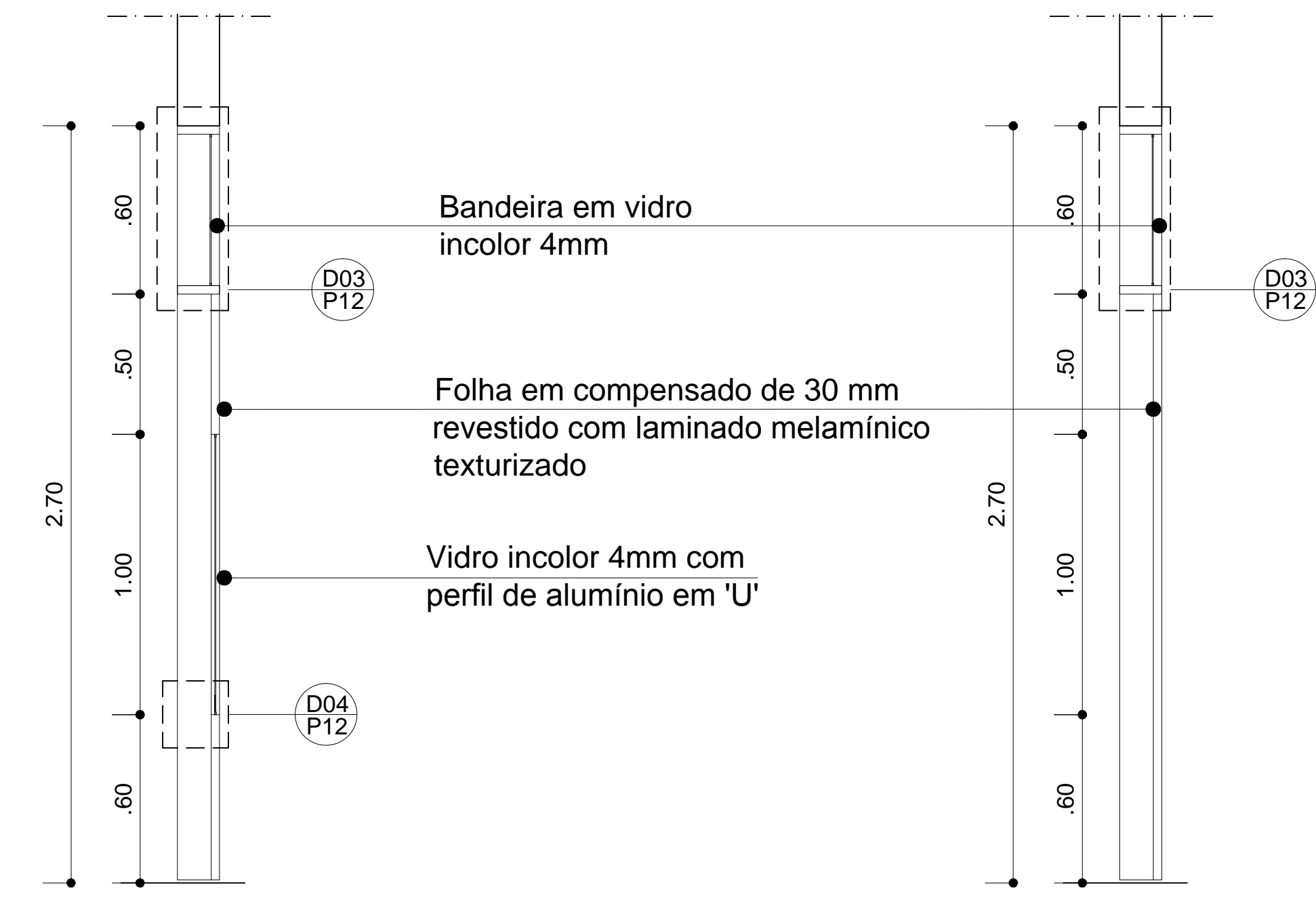

CORTE KK' - P1  
Esc 1/25

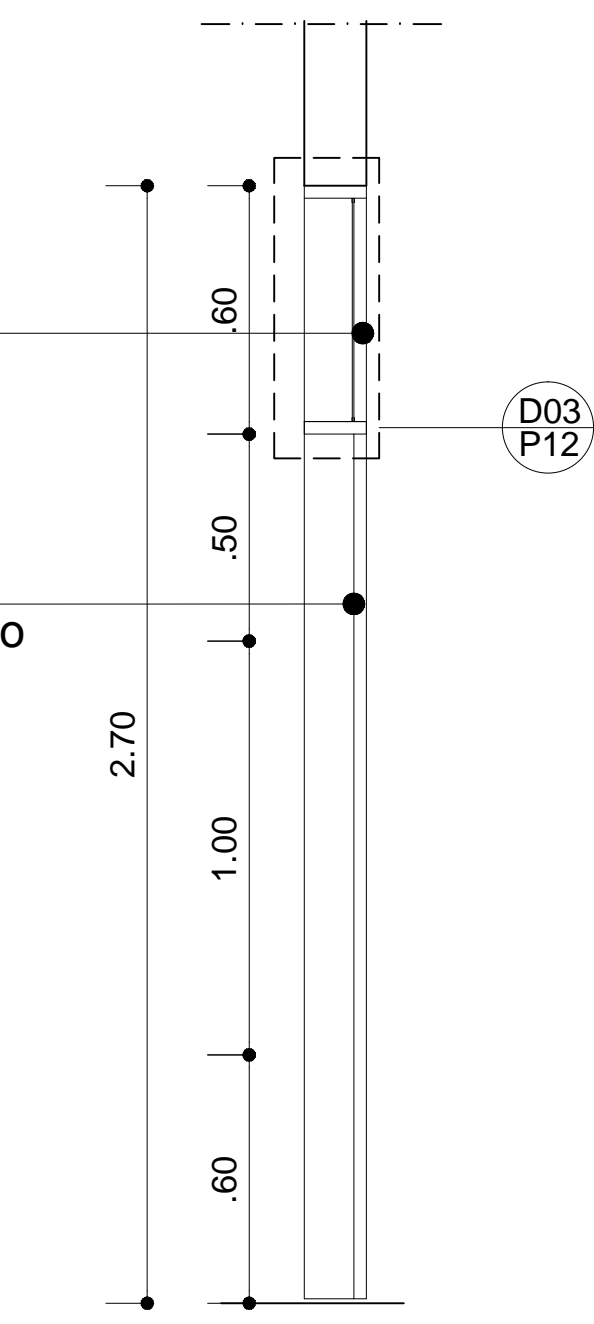

CORTE K1K1' - P2  
Esc 1/25

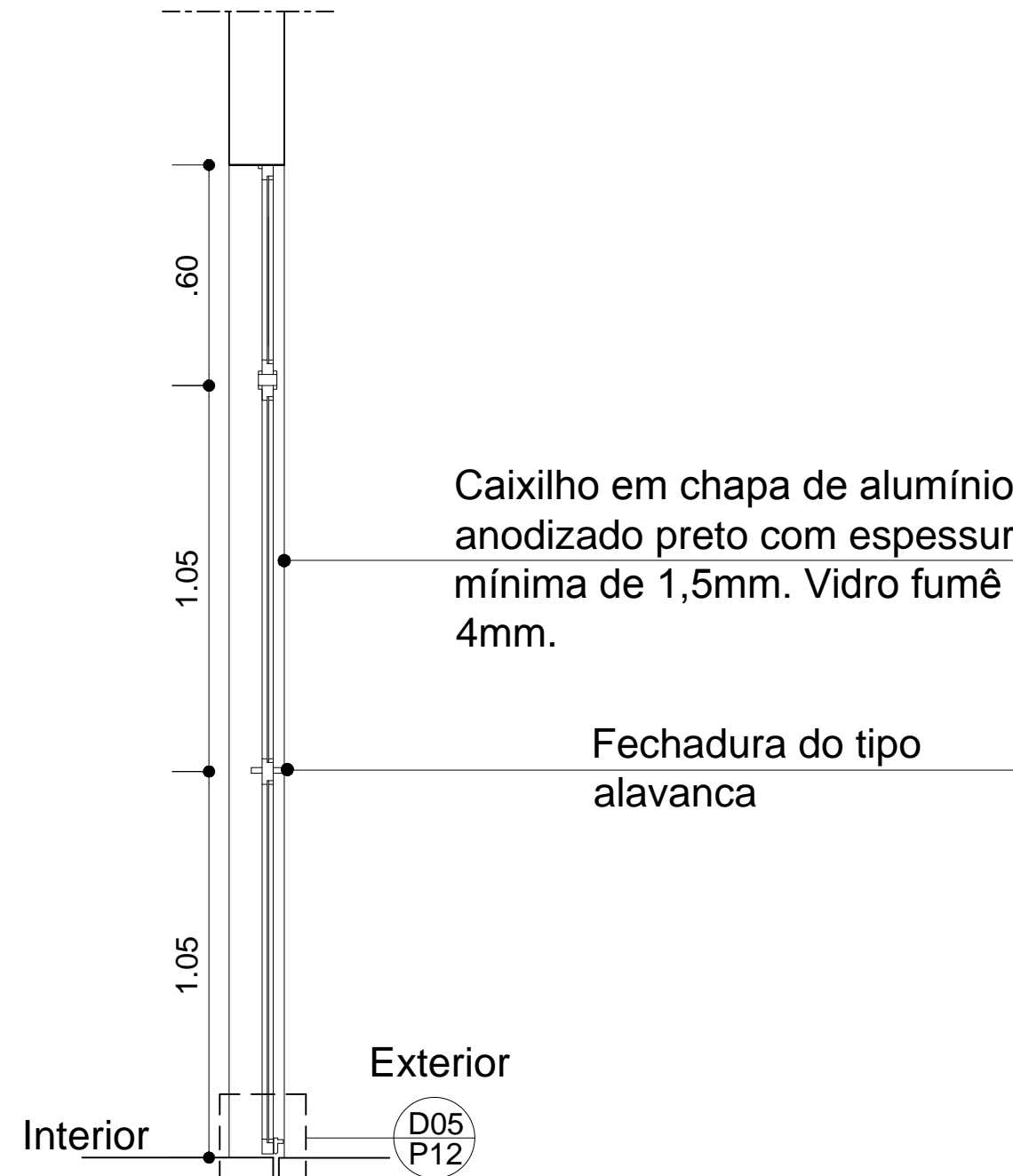

CORTE LL' - P6  
Esc 1/25

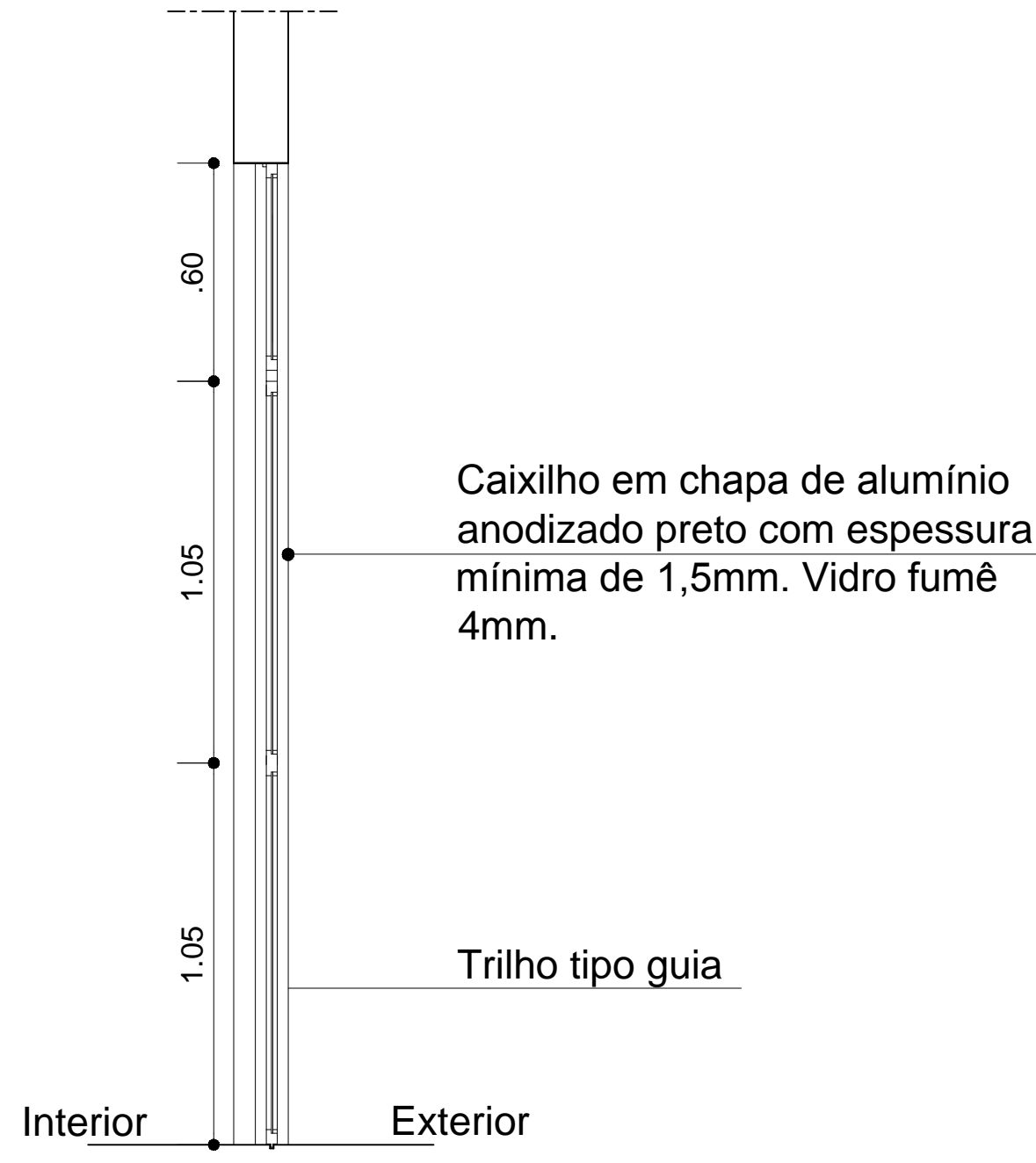

CORTE MM' - P7  
Esc 1/25

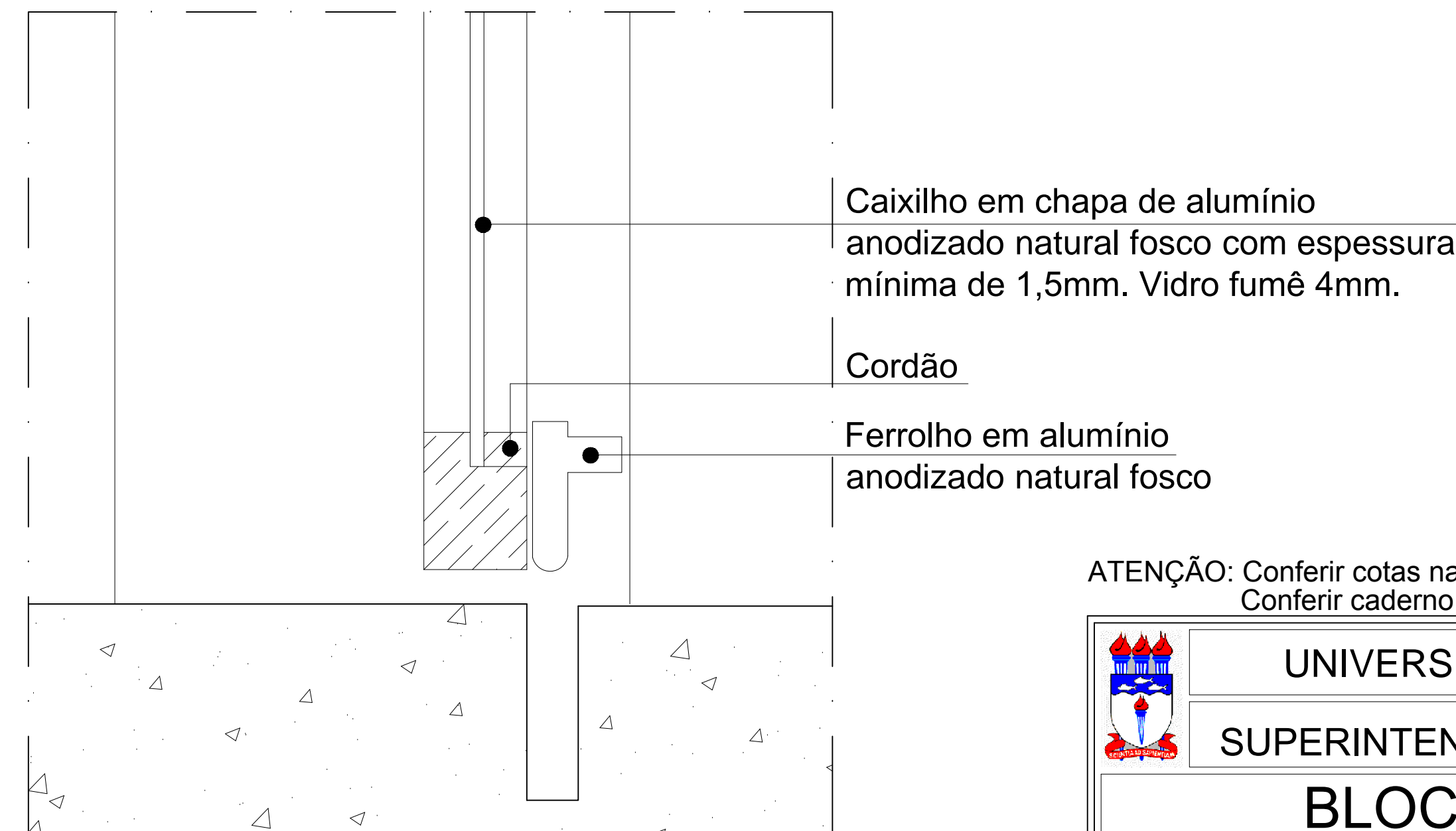

DETALHE 05  
Esc 1/2

ATENÇÃO: Conferir cotas na obra;  
Conferir caderno de especificações.

UNIVERSIDADE FEDERAL DE ALAGOAS - UFAL			
SUPERINTENDÊNCIA DE INFRAESTRUTURA - SINFRA			
BLOCO DE LABORATÓRIOS			
FACULDADE DE FARMÁCIA			
AUTOR: Daísy Damásio	Marlise Carvalho	Maurício Faustino	Vanine Borges
CREA: 8021 D/AL	7776 D/AL	8605 D/AL	8265 D/AL
DETALHAMENTO ESQUADRIAS: P. BAIXA P1,P6, P7			ÁREAS: TERRENO: 2.200m²
VISTAS FRONTAIS P1,P6,P7, CORTES P1,P6,P7, D03, D04			CONSTRUIDA: 638m²
DESENHO: Marlise Carvalho e Vanine Borges			COBERTA: 747m²
PRANCHA:			
DATA: 07.2009	ESCALA DE IMPRESSÃO:	1/25	